

# ASSEMBLY OF HONEYBEE PLAYHOUSE - ESSH1007

## Adult Assembly Only - Do not attempt to modify this Playhouse

Thank you and congratulations on the purchase of your European Shed Garden Building. We believe that this product will give you many years of excellent service. This is a natural product manufactured to a high standard. If you have any questions or experience any difficulties please call our toll free customer service hotline at **1.800.584.5840**. We are open 8am to 6pm Monday through Friday and 9am to 5pm MST on Saturday.

## PREPARATION OF BASE

The base on which your building will stand should be at least 3" larger in each direction than the total floor size of the building.

Actual floor size of the building: 3' 10" x 3' 10"

Total height clearance: 5' 1"

Your chosen installation site should be excavated to a depth of 3" to allow a base of sand on which paving stones can be evenly laid - THEY MUST BE LEVEL AND FIRM.

## TREATMENT/CARE OF YOUR GARDEN BUILDING

Prior to assembly, treat all pieces with a protective wood treatment (stain/finish/paint/sealant). It is recommended to treat your shed again within 3 months of assembly and on an annual basis.

Treat all panels in an upside-down position to allow the stain/finish/paint/sealant to get into the tongue and groove jointing.

It is unlikely you will be able to re-treat the underside of the floor following assembly. Therefore, it is strongly recommended to treat the underside of the floor at least twice prior to assembly. Use only child safe wood preservative and allow to dry thoroughly before further use. Do not use creosote.

## PARTS LIST

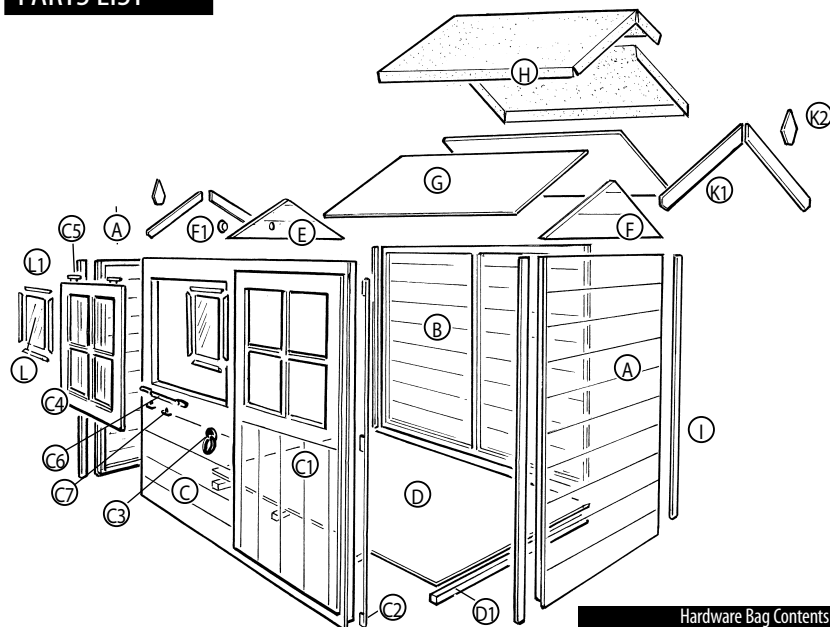

PLEASE LAY OUT PARTS AND CHECK OFF AGAINST CHECK LIST BELOW:

DESCRIPTION	QTY
Timber sections (A x2, B, C)	4
Door (C1)	1
Piano hinge (C2)	1
Window frame (C4)	1
Floor (D)	1
Floor Joists (D1 x4)	4
Front gable (E)	1
Back gable (F)	1
Roof pieces (G x2)	2
8 1/2" of roll felt (H)	1
Corner strips (I)	4
Plain fascia boards (K1)	4
Diamonds (K2)	2
Panes glazing material (L)	8
Pieces beading (L1)	32

## PLEASE NOTE

Wood is a natural product and is therefore prone to changes in appearance which include warping, movement and splitting, particularly during unusual climatic conditions (long hot or wet spells of weather). As a natural occurrence these natural changes are not covered by a guarantee.

# EUROPEAN SHEDS<sup>SM</sup>

■ Distinctive Quality & Craftsmanship ■

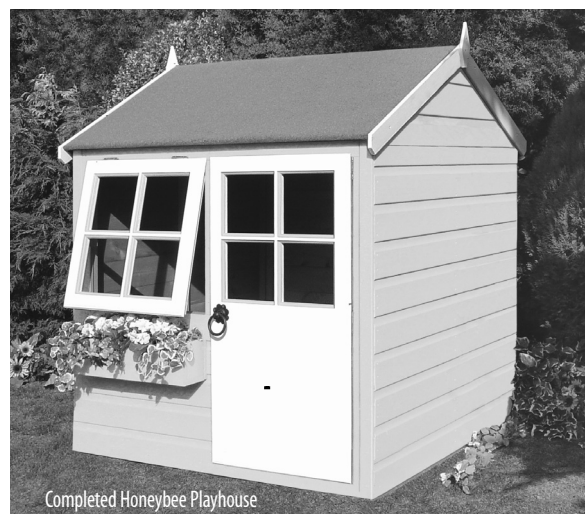

Completed Honeybee Playhouse

## TOOLS REQUIRED

- Screwdriver (electric is best)
- Drill and 6mm drill bit
- Hammer
- Sandpaper (to smooth any rough edges)
- Cutting knife
- Tape measure
- Step ladder
- Ruler
- Pencil
- Saw
- Chisel

## IMPORTANT!

PLEASE READ PRIOR TO ASSEMBLY

Every precaution is taken to ensure that your building arrives in the best possible condition. However, PRIOR TO USE please check all surfaces for the following:

1. RAISED GRAIN, SPLINTERS: sand down timber to smooth finish
  2. NAIL/SCREW/PIN HEADS PROUD: tap home to be flush with surface of timber
  3. DAMAGED SCREW HEADS RESULTING IN SHARP SPLINTERS OF METAL: replace
  4. SHARP ENDS OF NAILS/ SCREWS/ PINS PROTRUDING THROUGH THE PANEL: remove and reposition
  5. ENSURE ALL PARTS ARE SECURED AGAINST REASONABLE FORCE: remove and refit
  6. ENSURE THERE ARE NO LOOSE PARTS: remove and refit/discard
- WEAR PROTECTIVE GLOVES DURING ASSEMBLY

Hardware Bag Contents	
DESCRIPTION	QTY
Door handle (C3)	1
Window hinges (C5)	2
Casement stay (C6)	1
Casement stay pins (C7)	2
Door catch (C8)	1
Vents (F1)	2
12mm screws	4
60mm screws	20
25mm black screws	4
25mm screws	35
40mm nails	102
Panel pins	64
Felt nails	60



# ASSEMBLY OF BUILDING - Please read instructions prior to assembly

## A - Door Assembly

- At the top and bottom of the hinge side of the door, the corner of the weatherproof overhang needs to be removed. To do this, determine which side of the door the hinge will be fitted to allow either right or left opening. Place the door on a flat, level surface, face down. Measure 3/8" along each side of each corner. Draw a diagonal line connecting the two marks. Cut this triangular section off using a saw. Repeat.
- Place the piano hinge along the length of the door making sure that the hinge does not protrude at either top or bottom. Fit the small inner part of the hinge to the door using (6) 25 mm screws in total.
- Fit ring handle 'CS' to the door in line with the center door framework using (4) 25mm black screws.
- Fitting the door to the front panel: place the door into the aperture. Ensure there is an equal gap between the edges of the door and the aperture. Screw into position using (3) 25mm screws per hinge.

## B - Fit Window Frame C4 (from top)

- The hinges should be recessed into the window frames to a depth of 1/8". To do this place one hinge 'CS' on the inner rebated part of the top of the window. The rounded part of the hinge should sit above the outer edge. Mark the position of the hinge on the weatherproofing part of the window insert. Remove the hinge. Chisel out the timber to a depth of 1/8" in the positions marked. Repeat.
- Place the hinge back onto the insert and screw the inner piece into position using the predrilled holes in the hinge and (2) 25 mm screws. Repeat.
- Place the window into the aperture. Secure the window to the panel using (3) 25mm screws per hinge, again through the predrilled holes in the hinge. Repeat.
- Open the window and fit an additional (2) 25mm screws per hinge next to the one already fitted in Step 1. Repeat.
- Fitting the Casement Stay 'C6': place the casement stay centrally on the inside of the window. Place the 2 pins 'C7' under the casement stay. Position so that it is not resting on the framework of the panel and not so high that the pins are of no use.
- Fit the Casement Stay on the window using (2) 25mm screws.
- Mark where the pins will be placed.
- Secure into position using (4) 25mm screws - 2 in each pin.

## C - Floor and Wall Assembly

- Place two floor joists 'D1' flush with the outer edges of the floor. Nail in position using 40mm nails at 4" intervals.

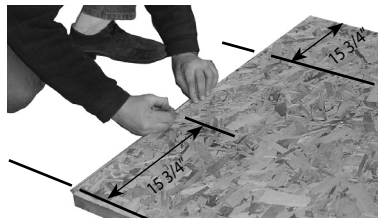

- Measure 15 3/4" in from the edge to mark center for next roof joist 'D1'. Repeat from opposite edge.

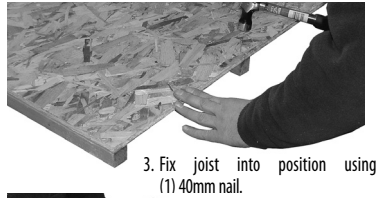

- Fix joist into position using (1) 40mm nail.



- Using a straight edge to indicate centers for existing nails, proceed in fixing joist using 40mm nails at 4" intervals.

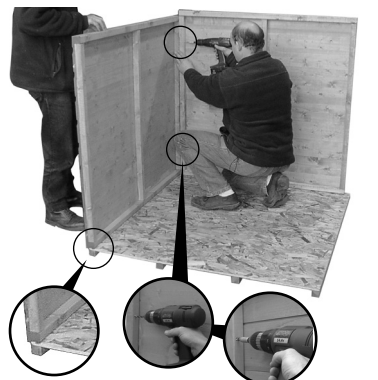

- Place the floor on a flat, level surface. Place 'A' and 'B' in position ensuring that the shiplap cladding overhangs the edge of the floor.

- Drill two holes, one to the top and one to the bottom. Do not drill into the panel 'A'. Secure the panels together using (2) 60mm screws. Repeat with similar panel 'A' on opposite side.

- Place the door panel 'C' in position. Drill both side panels and secure to the door panel using (2) 60mm screws at each side.

## D - Gable Assembly



- Drill 2 holes on the top joist vertically on panel 'A'.

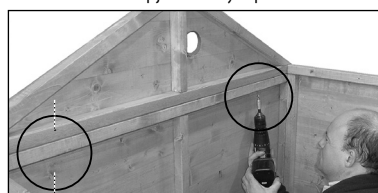

- Position gable panel 'F' into position ensuring that the gable is positioned evenly and flush along the top edge of the panel. Secure using (2) 60mm screws. Repeat.



- Place vents into the aperture in gable panel 'F'.

## E - Roof & Felt Assembly



- Open the roll of felt 'H'. Place on flat, clean surface and fold in two equal halves. Cut into two equal pieces on the fold using a cutting knife.

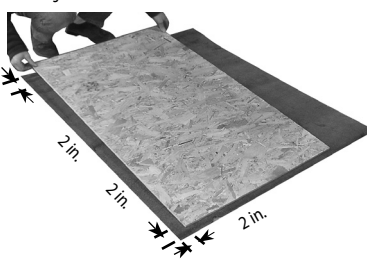

- Place roof panel 'G' on top of felt ensuring there is an overlap of approximately 2" on three sides.



- Fold over felt on longest edge with the 2" overlap and nail into position using felt nails at 4" intervals.

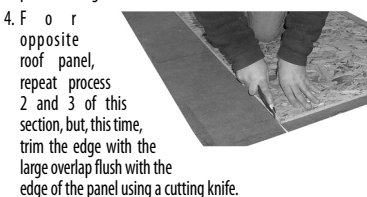

- For opposite roof panel, repeat process 2 and 3 of this section, but this time, trim the edge with the large overlap flush with the edge of the panel using a cutting knife.



- Place both roof panels on the building checking that they are flush with the outside edges of the building and at the ridge. The edge with felt nailed in place is the bottom edge. Nail the felt to the underside of the roof overhang. Secure both roof panels in position through the roof and into the framework of the walls and gables using (3) 40mm nails for each gable edge and (5) for each long edge. A total of (22) 40mm nails.

- One roof panel has the felt trimmed to be flush at the peak of the building. Place this felt in position and fix to the walls of the building using felt nails spaced at 4" intervals.



- Place the felt on the roof and over the ridge to overhang the other roof panel with felt already fitted in place. Secure the felt to the walls and along the overhang of the existing roof panel using felt nails spaced at 4".

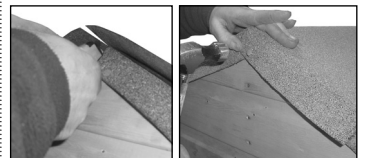

- On the underside of the outside corners, neatly cut, fold and secure using (1) felt nail.

## F - Corner strips

- Nail corner strips 'I' at each corner. Use (3) 40mm nails per strip.

## G - Facia boards and Diamonds



- Nail facia boards 'K1' into position using (3) 40mm nails per board. Repeat.

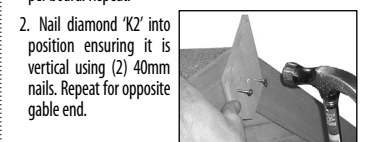

- Nail diamond 'K2' into position ensuring it is vertical using (2) 40mm nails. Repeat for opposite gable end.

## H - Securing Walls to Floor

- Screw all side panels to the floor on the inside of the building using (2) 60mm screws per separate panel, preferably into the floor joist.

## I - Glazing Material in Window & Door

- Remove protective film from both sides of each glazing pane of window glazing material 'L'.
- Place glazing material 'L' into the aperture of each window.
- Hold into position with four pieces of beading 'L1'. The beading may need to be swapped around to get the best fit. When satisfied, secure into position using (2) 15mm panel pins per piece of beading. Repeat for door window.

## J - Door catch Assembly

- Secure the pointed part of the door catch to the non-hinged edge of the door on the inside as shown. Fix into place using (2) 12mm screws.
- While inside the building, position the other part of the door catch into the pointed part of the catch and close the door. Fix into place using (2) 12mm screws.

## ASSEMBLY COMPLETION CHECKLIST

- Check and ensure that no raised grain or splinters are evident on timber components. Sand down any raised grain or splinters using fine grade sandpaper.
- Check that all screw, nail and pin heads are properly tapped home and are not proud of the timber surface.
- Check and ensure that no screws, nails or pins protrude through any panel.

- Check and ensure that all parts are properly secured against reasonable force.
- Do not apply decorative wood finish/treatments to wet or damp timber. Please observe the instructions of the wood finish/treatment manufacturer.
- Adults need to check the playhouse regularly and maintain the playhouse in good condition to provide a safe play environment. Do not use if damaged. If damaged the playhouse should be properly and safely repaired before further use by children.